

# Preview

COLLECTIONS



# Preview

COLLECTIONS

## A T T I V A T E A M P U Z Z L E

---

Un Direzionale che si articola in 4 versioni,  
un Operativo che ne racchiude 5  
ed un sistema di workstations che apre ad infinite possibilità compositive:  
ecco le anteprime di prodotto che Codutti ha in serbo per Voi,  
una per ciascun livello di gamma

An executive collection in 4 versions,  
An operative one that incorporates 5 variations  
a workstations concept that assure endless compositions:  
here's a preview of our new products,  
how Codutti conceived it to cover each level range



# ATTIVA

Direzionale dalle linee essenziali e moderne, declinato in quattro versioni, quante sono le geometrie dei supporti del top. Classica la *Pannellata*, con fianco collegato a 90° tramite un profilo sagomato in alluminio lucido. Contemporanee le varianti a *Ponte* e *Anello* in tubo triangolare, disponibili cromate o verniciate. Moderna la *Conica*, con gambe in acciaio a sezione semiellittica, da scegliere fra verniciate o rivestite in cuoio. Tre i materiali per i top, le ante, i frontali e i contro fianchi: legno frassino nelle finiture corda e terra; laccato opaco sabbia e piombo; melaminico bianco, noce e wengè. E ancora, per i soli top, il vetro laccato bianco o nero. Funzionali allunghi integrati alle scrivanie con porte scorrevoli e la libreria con top e controfianchi collegati dal raffinato profilo lucido - piacevoli per riporre le cose che parlano della propria personalità - completano la proposta di *Attiva*. Gli accessori sono naturalmente coordinati, come da tradizione Codutti.

Executive furnishings with clean-cut, modern lines, available in four versions and four different top support shapes. Classic *Panelled side*, with side connected at 90° with a shaped profile in polished aluminium. Contemporary *Bridge* and *Ring* versions in triangular tubing, available painted or chrome plated. Modern *Conical*, with steel, semi-oval legs, available painted or covered with thick leather. Three materials for tops, doors, fronts and counter sides: ash wood in the finishes corda and terra; matt lacquered, sand and gunmetal; white melamine, walnut and wengè. And again, for the tops only, lacquered glass in black or white. Functional extensions integrated to desks, with sliding doors and bookcase with top and counter sides connected by an elegant polished profile - a great way to store the items that talk about your personality - complete the *Attiva* range. Accessories are naturally coordinated, as per Codutti traditions.

TOP E FRONTALI TOP AND FRONTALS	<b>MB29</b>	<b>MN31</b>	<b>MQ23</b>	Legno/Wood	<b>GC22</b>	<b>GM23</b>	Laccato/Lacquered	<b>FP61</b>	<b>FS60</b>	
	Melaminico/Melamine	Bianco White	Noce Walnut		Wengè Wengè	Frassino tinto corda Corda dyed ash		Frassino tinto terra Terra dyed ash	Piombo Gunmetal	Sabbia Sand
TOP	<b>VB72</b>	<b>VN70</b>	STRUTTURA STRUCTURE		<b>MB29</b>	<b>ME28</b>				
	Vetro/Glass	Bianco White	Nero Black	Melaminico/Melamine	Bianco White	Nero Black				
GAMBE LEGS	<b>EB48</b>	<b>EE47</b>	<b>AC82</b>	Cuoio/Thick Leather	<b>CN72</b>	<b>CT86</b>	<b>CJ83</b>			
	Metallo/Metal	Vern. Bianco White painted	Vern. Nero Black painted		Cromato Chromed	Nero Black	Tortora Dove grey	Bianco White		



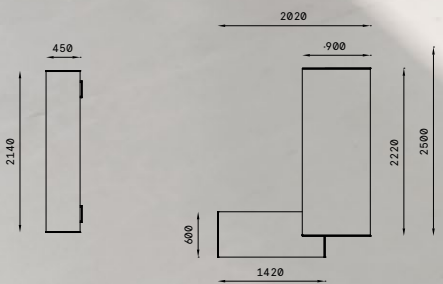

**Struttura/Structure:**  
MB29 Melaminico Bianco  
MB29 White Melamine

**Top e Frontali /Top and Frontals:**  
GM23 Legno Acero tinto Terra  
GM23 Ash dyed terra wood

**Inserti/Inserts:**  
CN72 Cuoio nero  
CN72 Black Thick Leather

# ATTIVA

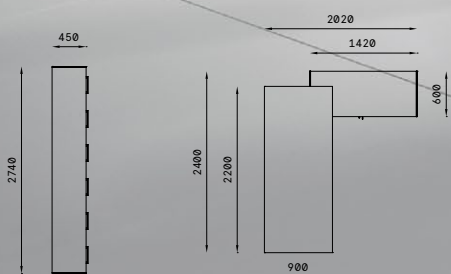

**Struttura/Structure:**  
 ME28 Melaminico Nero  
 ME28 Black Melamine

**Top e Frontali /Top and Frontals:**  
 GC22 Legno Acero tinto Corda  
 GC22 Ash dyed Corda wood

**Gambe/Legs:**  
 AC82 Cromato  
 AC82 Chromed

**Inseri/Inserts:**  
 CN72 Cuoio nero  
 CN72 Black Thick Leather

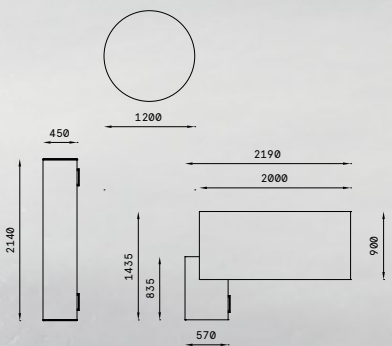

**Struttura/Structure:**  
ME28 Melaminico Nero  
ME28 Black Melamine

**Top e Frontali /Top and Frontals:**  
FS60 Laccato Sabbia  
FS60 Sand Lacquered

**Gambe/Legs:**  
CT86 Cuoio Tortora  
CT86 Dove Grey Thick Leather

**Inseri/Inserts:**  
CT86 Cuoio Tortora  
CT86 Dove Grey Thick Leather

ATTIVA

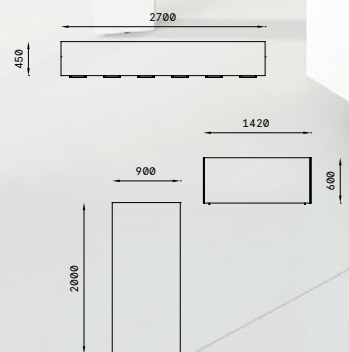

**Struttura/Structure:**  
MB29 Melaminico Bianco  
MB29 White Melamine

**Top:**  
VB72 Vetro Laccato Bianco  
VB72 White lacquered Glass

**Frontali/Frontals:**  
MQ23 Melaminico Wengè  
MQ23 Wenge Melamine

**Gambe/Legs:**  
EB48 Metallo verniciato bianco  
EB48 White painted metal

**Inserti/Inserts:**  
CN72 Cuoio nero  
CN72 Black Thick Leather

# TEAM

Progetto di arredo operativo vasto e articolato, pensato per dare una risposta alle più svariate esigenze tecniche ed estetiche. Cinque versioni, dalle linee attuali e nello stesso tempo tradizionali.

La *Pannellata* ha il fianco in melaminico collegato al top tramite un distanziale in inox lucido. I fianchi a *Ponte* e *Anello* in tubo rettangolare sono verniciati, come quelli a *T rovesciata*. Completa la gamma la *Conica*, con gambe a sezione semiellittica in acciaio stampato. Lavoro di squadra con il system bench dal fianco a Ponte o Conico: postazioni dotate di schermi - anche in stoffa - lampade, porta monitor... vano tecnico in alluminio satinato. Garantite funzionalità, estetica ed ergonomia.

Vast, well-designed operational furniture, designed to be the answer to a host of technical and aesthetic requirements. Five versions, with current styling that manages to remain within the realms of tradition.

*Pannelled side* has a side in melamine, connected to the top via polished stainless steel spacer. The *Bridge* and *Ring* sides in rectangular piping are painted, as per the one looking like *T leg*. The range is completed by *Conical*, with semi-oval legs in moulded steel. Teamwork with the bench system alongside *Bridge* or *Conical*: workstations with screens - including in fabric - lamp, monitor stand... technical compartment in satin-finish aluminium. Guaranteed practical use, aesthetics and ergonomics.

	MB29	MN31	MR30	MP25	MQ23
<b>TOP E FRONTALI</b> TOP AND FRONTALS	Melaminico/Melamine				
					
	Bianco White	Noce Walnut	Rovere Oak	Perla Pearl	Wengè Wengè
<b>STRUTTURA</b> STRUCTURE	Melaminico/Melamine				
					
	Bianco White	Alluminio Aluminium			
<b>GAMBE</b> LEGS	Metallo/Metal				
					
	Vern. Bianco White painted	Vern. Nero Black painted			

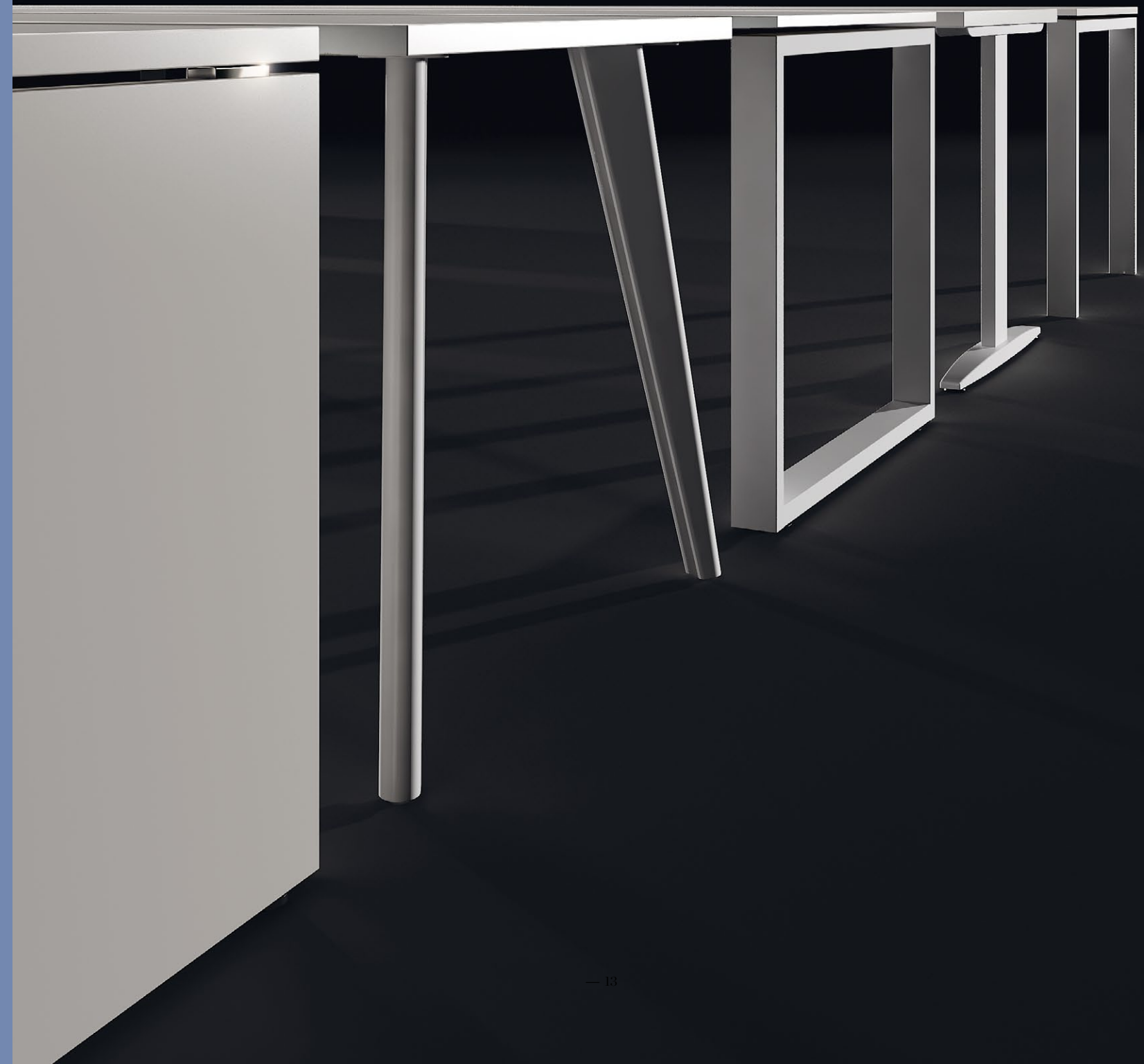

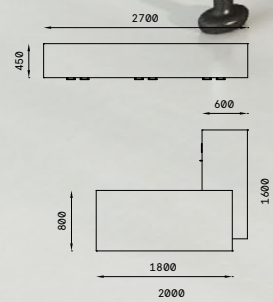

**Struttura/Structure:**  
 MB29 Melaminico Bianco  
 MB29 White Melamine

**Top e Frontali /Top and Frontals:**  
 MN31 Melaminico Noce  
 MN31 Walnut Melamine

**Accessori/Accessories:**  
 CN72 Cuoio nero  
 CN72 Black Thick Leather

# TEAM

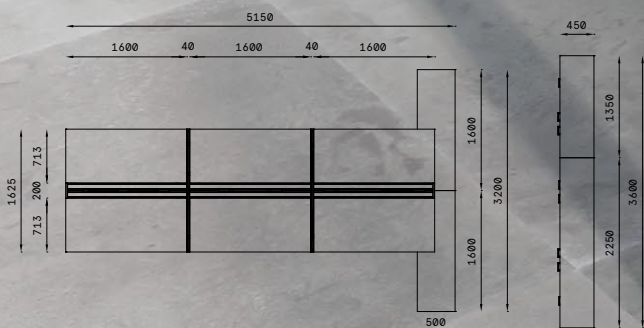

16

**Struttura/Structure:**  
 MM21 Melaminico Alluminio  
 MM21 Aluminium Melamine

**Top e Frontali /Top and Frontals:**  
 MP25 Melaminico Perla  
 MP25 Pearl Melamine

**Gambe/Legs:**  
 EM41 Metallo verniciato alluminio  
 EM41 Aluminium painted metal

# TEAM

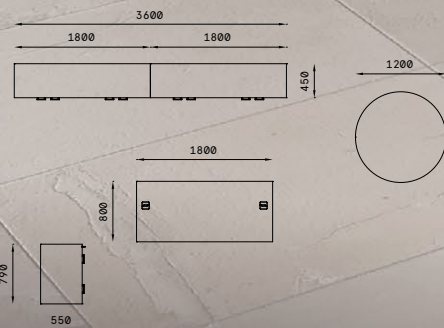

**Struttura/Structure:**  
MB29 Melaminico Bianco  
MB29 White Melamine

**Top e Frontali /Top and Frontals:**  
MQ23 Melaminico Wengè  
MQ23 Wenge Melamine

**Gambe/Legs:**  
EB48 Metallo verniciato bianco  
EB48 White painted metal

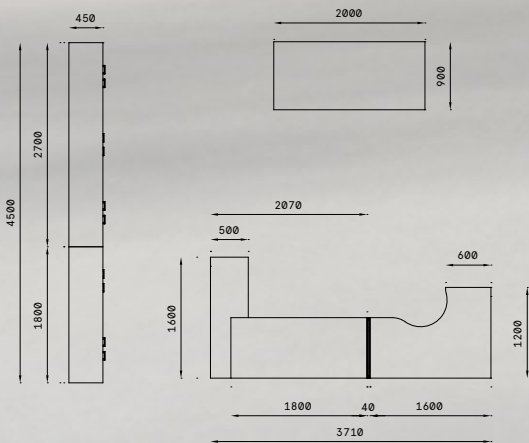

**Struttura/Structure:**  
 MB29 Melaminico Bianco  
 MB29 White Melamine

**Top e Frontali /Top and Frontals:**  
 MR30 Melaminico Rovere  
 MR30 Oak Melamine

**Gambe/Legs:**  
 EB48 Metallo verniciato bianco  
 EB48 White painted metal

**Accessori/Accessories:**  
 CN72 Cuoio nero  
 CN72 Black Thick Leather

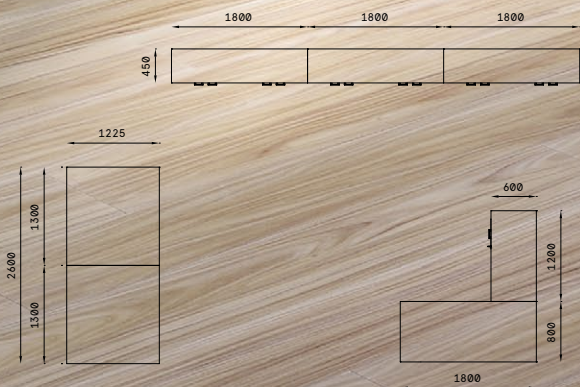

**Struttura/Structure:**  
 MB29 Melaminico Bianco  
 MB29 White Melamine

**Top e Frontali /Top and Frontals:**  
 MB29 Melaminico Bianco  
 MB29 White Melamine

**Gambe/Legs:**  
 EB48 Metallo verniciato bianco  
 EB48 White painted metal

**Accessori/Accessories:**  
 CN72 Cuoio nero  
 CN72 Black Thick Leather

# PUZZLE

È un sistema aperto per posti di lavoro con soluzioni infinite, dove la flessibilità nel progettare è totale. Con Puzzle la composizione dell'arredo si realizza sulle esigenze del cliente e si può modificare a ogni nuova necessità operativa. Le paretine da 82 mm di spessore hanno struttura in acciaio e profili di finitura in alluminio verniciato. I tamponamenti sono in melaminico o rivestiti in stoffa. I piani di lavoro, sempre in melaminico da 30 mm, sono bordati in ABS. I fianchi terminali sono quelli della linea Team nelle versioni *Pannellata*, *Conica* e *T rovesciata*. La canalizzazione è sempre presente e i componenti accessori rispondono a tutte le necessità tecniche di utilizzo.

This is an open system for workstations with a host of infinite solutions, where design flexibility is total. With Puzzle, the furnishing layout is created to suit the client and it can be changed to suit any new operational requirement. The partitions, 82 mm thick, have steel structures and painted aluminium finish profiles. The claddings are in melamine or covered in fabric. The worktops in 30 mm melamine are edged in ABS. The finishing panels are taken from the Team line in the versions *Panelled side*, *Conical* and *T leg*. Ducting is always fitted and the accessory parts comply with all of the user's technical requirements.

PARETINE SMALL WALLS	MB29	MN31	MQ23	MR30	MP25	MM21	
	Bianco White	Noce Walnut	Wengè Wengè	Rovere Oak	Perla Pearl	Alluminio Aluminium	
STRUTTURA ARREDI FURNITURE STRUCTURE	MB29	MM21	ME28	STRUTTURA PARETE WALL STRUCTURE		EB48	EM41
	Bianco White	Alluminio Aluminium	Nero Black	Metallo/Metal		Vern. bianco White painted	Vern. alluminio Aluminium painted
TOP E FRONTALI TOP AND FRONTALS	MB29	MN31	MQ23	MR30	MP25		
	Bianco White	Noce Walnut	Wengè Wengè	Rovere Oak	Perla Pearl		

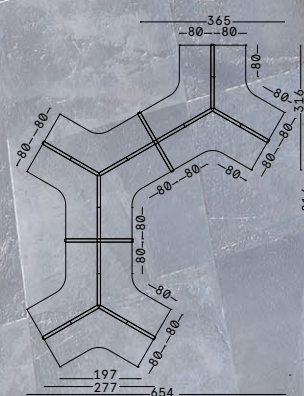

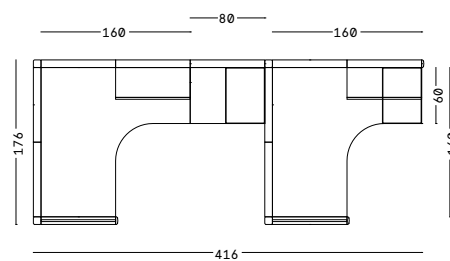

**Piani/ Worktops:**  
 MQ23 melaminico wengè  
 MQ23 wengè melamine  
**Struttura/ Structure:**  
 EM41 verniciata alluminio  
 EM41 aluminum painted

**Pannelli paretina/ Partitions:**  
 MM21 melaminico alluminio  
 IR83 tessuto Trevira rosso  
 MM21 aluminum melamine  
 IR83 red Trevira fabric

**Rivestimenti/ Upholstery:**  
 IR83 tessuto Trevira rosso  
 IR83 red Trevira fabric



**Piani/ Worktops:**  
 MN31 melaminico noce  
 MN31 walnut melamine  
**Struttura/ Structure:**  
 EM41 verniciata alluminio  
 EM41 aluminum painted

**Pannelli paretina/ Partitions:**  
 MN31 melaminico noce  
 MM21 melaminico alluminio  
 MN31 walnut melamine  
 MM21 aluminum melamine

**Rivestimenti/ Upholstery:**  
 IR83 tessuto Trevira rosso  
 IR83 red Trevira fabric

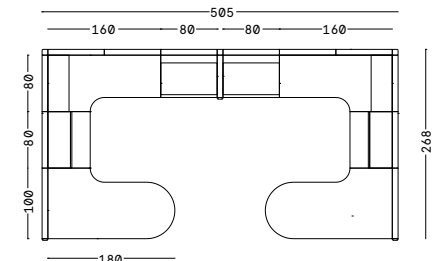

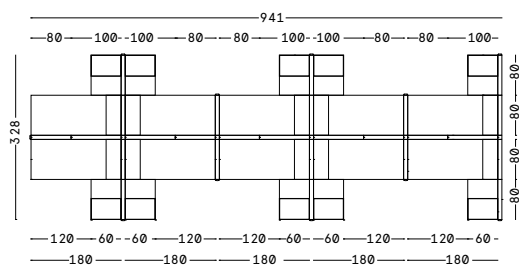

**Piani/ Worktops:**  
 MR30 melaminico rovere  
 MR30 oak melamine  
**Struttura/ Structure:**  
 EM41 verniciata alluminio  
 EM41 aluminum painted

**Pannelli paretina/ Partitions:**  
 MB29 melaminico bianco  
 NZ05 acrilico blu  
 MB29 white melamine  
 NZ05 blue acrylic

**Rivestimenti/ Upholstery:**  
 NZ05 acrilico blu  
 NZ05 blue acrylic

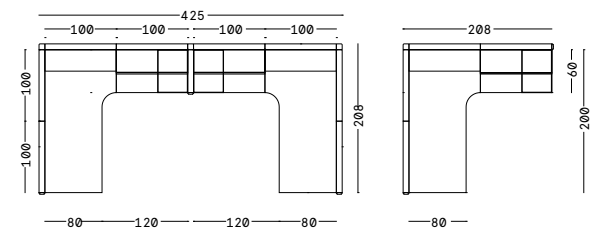

**Piani/ Worktops:**  
 MR30 melaminico rovere  
 MR30 oak melamine  
**Struttura/ Structure:**  
 EM41 verniciata alluminio  
 EM41 aluminum painted

**Pannelli paretina/ Partitions:**  
 MB29 melaminico bianco  
 IV84 tessuto Trevira verde  
 MB29 white melamine  
 IV84 green Trevira fabric

**Rivestimenti/ Upholstery:**  
 IV84 tessuto Trevira verde  
 IV84 green Trevira fabric

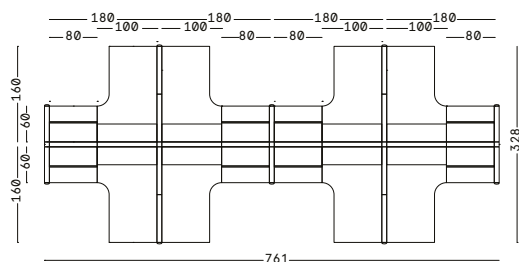

**Piani/ Worktops:**  
 MN31 melaminico noce  
 MN31 walnut melamine  
**Struttura/ Structure:**  
 EM41 verniciata alluminio  
 EM41 aluminum painted

**Pannelli paretina/ Partitions:**  
 MN31 melaminico noce  
 MM21 melaminico alluminio  
 MN31 walnut melamine  
 MM21 aluminum melamine

**Rivestimenti/ Upholstery:**  
 IZ85 Trevira blu  
 IZ85 blue Trevira fabric

## Disegni/Drawings

### Modularità paretine Puzzle | Puzzle partitions modularity

Modulo | Module H 74cm



Modulo | Module H 106cm



Modulo | Module H 119cm



Modulo | Module H 138cm



Modulo | Module H 151cm



Modulo | Module H 170cm



Modulo | Module H 183cm

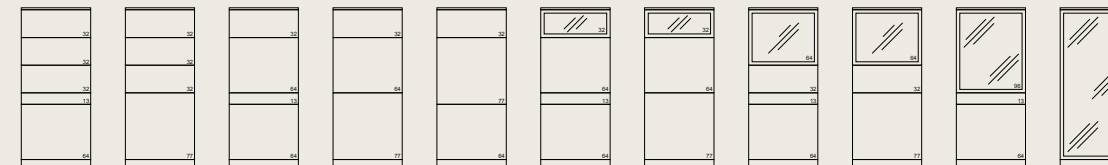

**Images**  
Primastudio  
Ufficio Tecnico Codutti

**Print**  
Grafiche Filacorda/Italy  
march 2015

Copyright© 2015  
by Codutti S.p.A.



**Codutti S.p.A.**

Via Bonavilla, 24  
33037 Pasian di Prato  
Fr. Passons (UD) ITALIA  
Tel. +39 0432 541414  
Fax +39 0432 540045  
codutti@codutti.it  
www.codutti.it



